



Catalina 36

mark II



T H E S A I L O R S ' C H O I C E



Because the Catalina 36 is easily handled by a couple, has a big comfortable cockpit, a spacious interior with two private cabins and the integrity to pursue cruising dreams, many experienced sailors consider the Catalina 36 the perfect boat for their sailing lifestyle.

The Catalina 36markII has all the important characteristics that made the original the most popular thirty-six foot sailboat in the world. The new Catalina 36mkII is built in the same seakindly moderate displacement hull that tracks surely and performs well in a variety of conditions. The deck is the classic trunk cabin configuration designed by sailors, not stylists, so it's proven, comfortable and functional.

The 36 is the evolution of this successful design and incorporates the refinement that is possible only after building over 1,700 36's and listening carefully to owners comments and suggestions.

The new interior has an aft cabin with a large athwartship double berth, hanging locker and bureau.

The owner's cabin forward is comfortable and well ventilated and has a private entrance to the head.

Cruisers love storage space and the Catalina 36 is renowned for it. There are ample drawers, lockers and bins for all your cruising provisions and gear.



The galley and main cabin have received special attention to design and detail. The galley is a functional 'U' shape, with composite counter tops, sinks are near centerline for proper drainage underway. A large refrigerated ice box is aft and a dry food locker is forward. A gimballed, stainless steel LPG stove with oven is standard equipment.

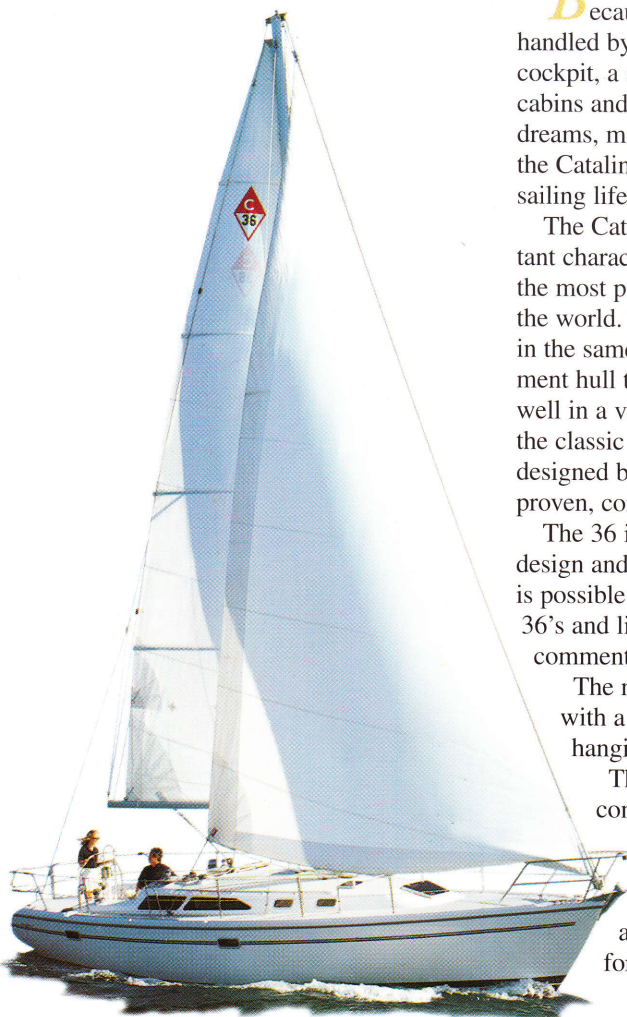

Catalina 36



All interior finishes and fabrics have been selected for quality, appearance and durability.

An important but often unconsidered aspect of boat ownership is maintenance. The new 36 has stainless steel hand rails and anodized spars, reducing maintenance on deck and extending your sailing season.

The mechanical, electrical and plumbing systems have been reengineered to increase dependability and accessibility. Engine access, for example, is excellent, with the one piece insulated enclosure removed.

Aft of the engine a mechanical compart-

ment contains the engine valves and filters. This makes maintenance and service easier.

The structural system and construction of the Catalina 36 is proven and straightforward. The hull structure is rugged, hand-laminated, solid fiberglass; the keel is lead with integrally cast stainless steel bolts.

The mast is stepped through the deck on the keel and has inline spreaders and fore and aft lower shrouds, a sturdy arrangement that is easy to tune.

Board a Catalina 36, inspect her thoroughly and discover why the 36 has become the sailors choice.

The main cabin can be arranged with a dinette or traditional table at your option. The two seats and game table to starboard can be made into a settee or berth with the cushions provided. The entertainment center cabinet can be fitted with a stereo and concealed TV. All interior teak has the warmth and durability only obtained with multiple coats of varnish.



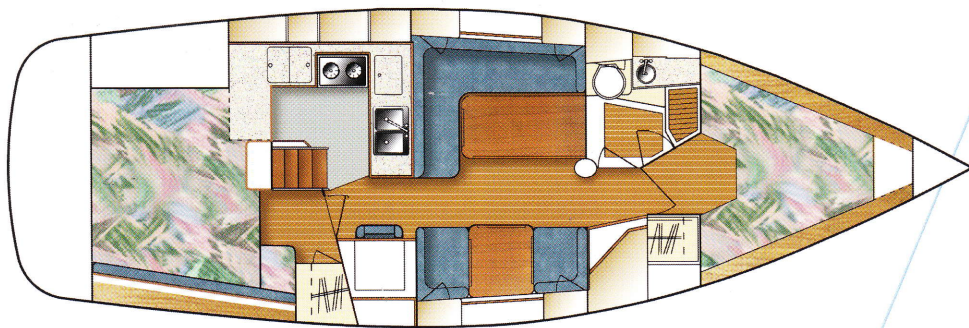

CATALINA 36mkl Principal Specifications

LOA		11.07m	36' 4"
LWL		9.22m	30' 3"
Beam		3.63m	11' 11"
Draft	Wing Keel	1.17m	4' 5"
	Fin Keel	1.78m	5' 10"
Ballast	Wing Keel	2990kg	6600 lb.
	Fin Keel	2718kg	6000 lb.
Approx.. Weight	Wing Keel	6387kg	14,100 lb.
	Fin Keel	6166kg	13,500 lb.
Engine Diesel		4cylinder	30 HP

Sail Area Standard Rig

(100% foretriangle)	51.56m ²	555 sq.ft.
I	13.64m	44' 9"
J	4.37m	14' 4"
P	11.89m	39' 0"
E	3.66m	12' 0"

Sail Area Tall Rig

(100% foretriangle)	55.83m ²	601 sq.ft.
I	14.25m	46' 9"
J	4.37m	14' 4"
P	12.50m	41' 0"
E	3.96m	13' 0"

All measurements are approximate and subject to change without notice.

Catalina Yachts

21200 Victory Boulevard Woodland Hills, CA 91367
 Phone (818) 884-7700 Fax (818) 884-3810
 e-mail: catalina@catalina.net
 http://www.catalina.net

Sold and Serviced by:

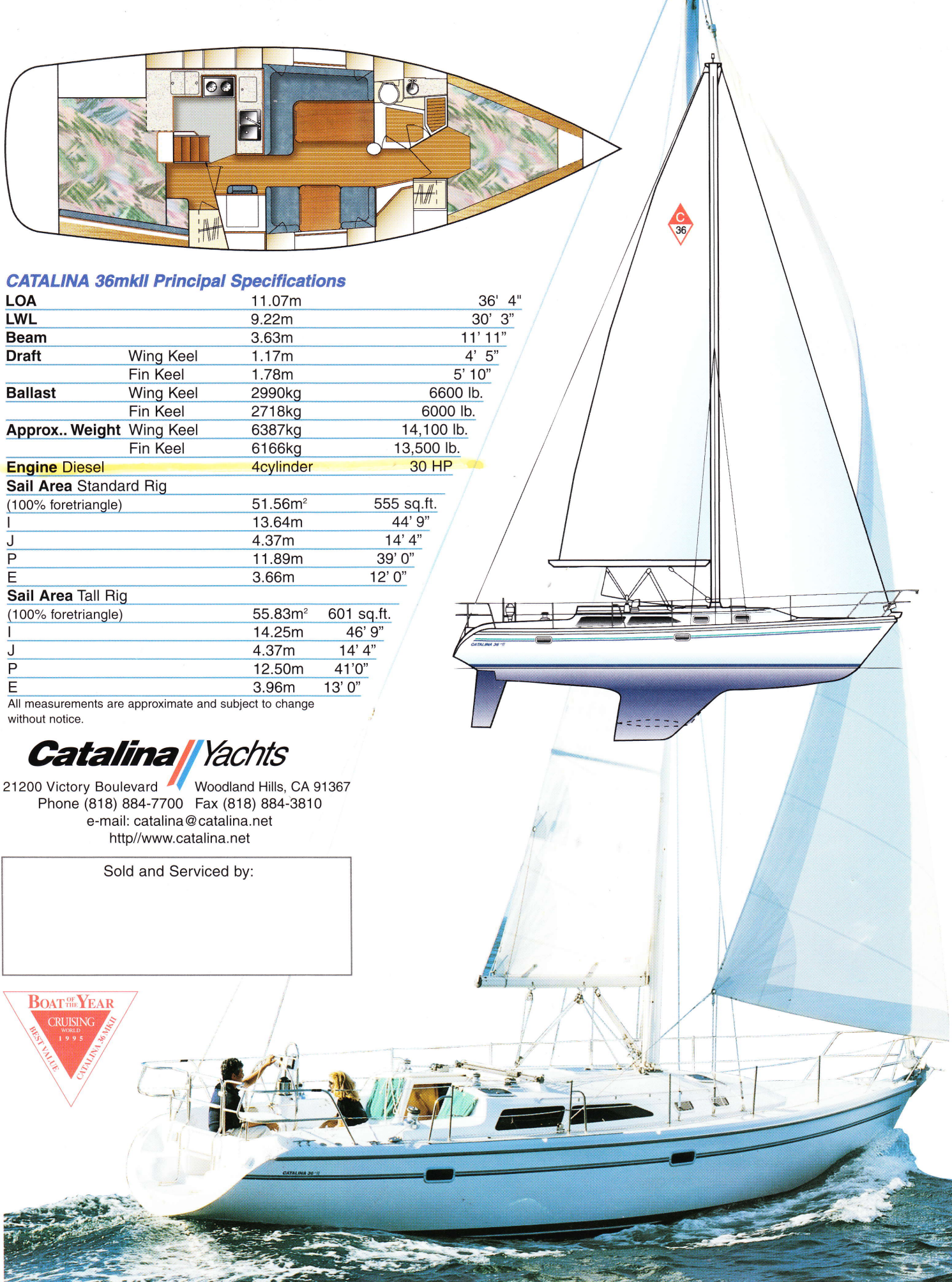
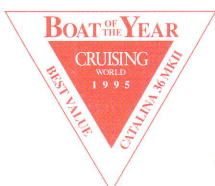

member: Certified National Marine Manufacturers Association 

member: **ABYC**
 Setting the Standards for Safer Boating

gel-coatings
 by

 **NESTE**
 Chemicals

Photos and drawings may show optional equipment. Refer to current price sheet for standard equipment list and specifications. 12.97